

# Silverline Pro 8

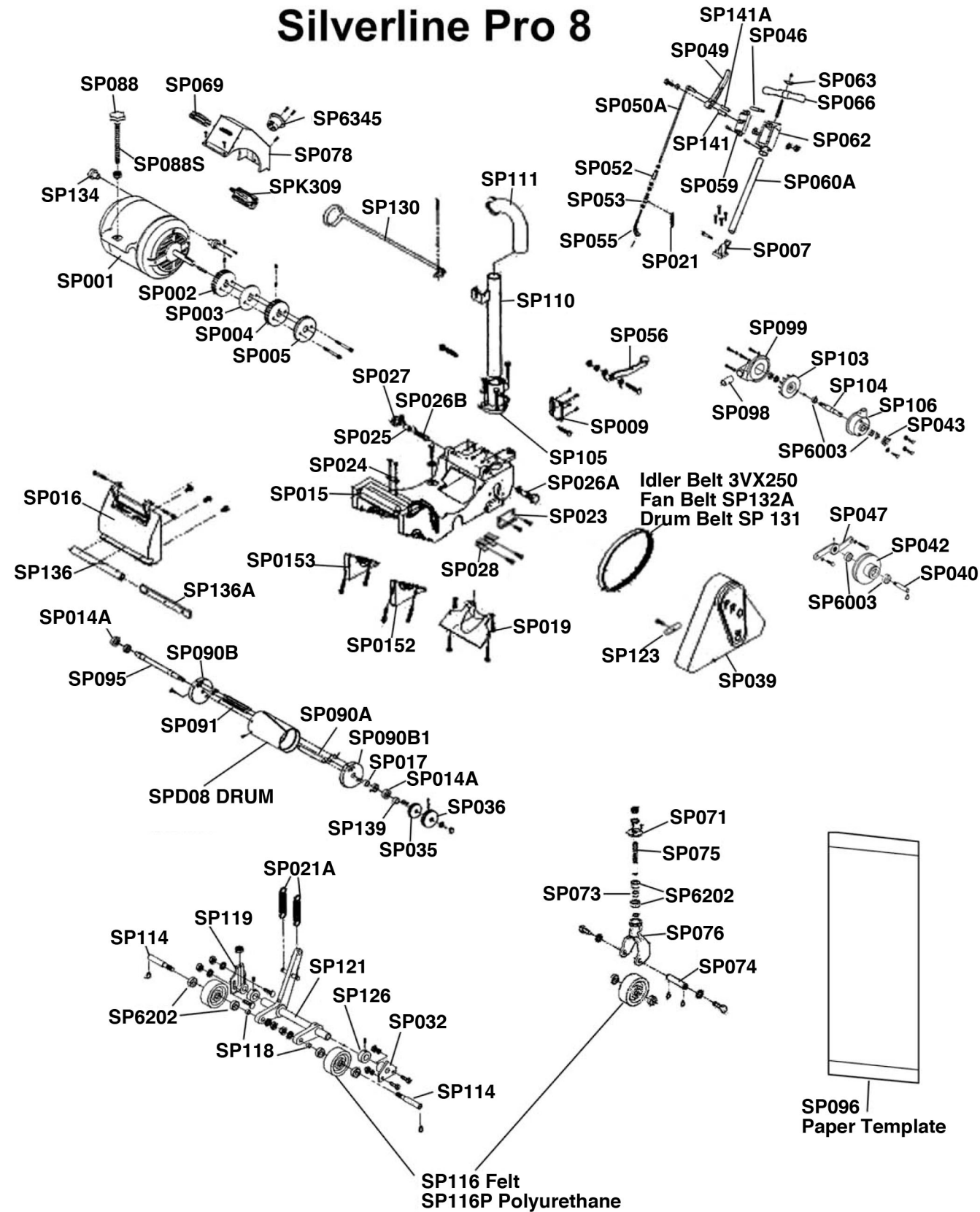

Part	Description
3VX250	Belt, Idler
SP6003	Bearing
SP6202	Bearing
SP6345	Inlet 250v 30amp
SPK309	Switch, 30 Amp
SPD08	8" Recovered Drum
SP002	Pulley, Large Inner Motor
SP003	Spacer Flange for Pulley 3hp
SP004	Pulley, Motor Small Outer 3hp
SP005	Pulley, Motor Fan 3hp
SP007	Handle Base
SP009	Plate, Pressure Control
SP014A	Bushing, Drum Shaft
SP015	Chassis
SP016	Drum Cover
SP017	Spacer, Inner Drum
SP019	Dust Pan
SP021	Spring Floor Control
SP021A	Spring, Carriage Assembly
SP023	Belt Guard Bracket
SP024	Plate, Motor Adjuster
SP025	Pin, Motor
SP026A	Pin Bushing, Motor Left
SP026B	Pin Bushing, Motor Right
SP027	Pin Knob, Motor
SP028	Belt Guard Clip
SP032	Plate, Left Support
SP035	Pulley, Inner Drum 3hp
SP036	Pulley, Drum, Large Outer
SP039	Belt Guard
SP040	Shaft, Idler
SP042	Pulley, Idler
SP043	Pulley, Fan
SP046	Pin, Stop, Control Handle
SP047	Idler Pulley Bracket
SP049	Control Handle
SP050A	Control Rod, Upper, Long
SP052	Control Rod Coupling
SP053	Plate, Spring
SP055	Control Rod, Lower
SP056	Tension Lever
SP059	Handle Box Cover
SP060A	Handle Tube, Long
SP062	Handle Box
SP063	Handle Clamp
SP066	Handle, Wooden
SP069	Switch Guard
SP071	Plate, Castor
SP073	Spacer, Castor Pivot
SP074	Castor Pivot
SP075	Castor Stud
SP076	Yoke, Caster No Wheel
SP078	Switch Box
SP088	Motor Adjust Screw Assembly
SP088S	Motor Adjusting Screw Stud
SP090A	Clamp, Paper

Part	Description
SP090B	Cap, Drum End w/key slot
SP090B1	Cap, Pulley Side Drum End
SP091	Drum Counterweight
SP095	Drum Shaft
SP096	Template 8"
SP098	Sleeve, Dust Pan
SP099	Fan Housing Cover
SP103	Fan
SP104	Fan Shaft
SP015	Dust Pipe Support
SP106	Fan Housing
SP110	Dust Pipe
SP111	Dust Elbow
SP114	Wheel Axle, Front
SP116	Wheel, Felt
SP116P	Wheel, Polyurethane
SP118	Spacer, Front Wheel
SP119	Wheel Truck Support, Right
SP121	Wheel Truck
SP123	Pin, Belt Guard
SP126	Collar
SP130	Cord Support
SP131	Belt, Power Cog
SP132A	Fan Belt
SP134	Motor Mount
SP136	Bumper
SP136A	Bumper Bracket
SP139	Spacer, Outer Drum
SP141	Bushing, Control Handle
SP141A	Control Handle Bushing
SP152	Bearing Cap, Left
SP153	Bearing Cap, Right